

### GENERAL

Mammoth™ 100% polyester insulation is safe and easy to install. Mammoth Panel Absorber insulation is designed to be used as an interior surface lining in commercial or residential spaces to help reduce noise reverberation.

### BEFORE YOU GET STARTED

#### THINGS TO LOOK OUT FOR

- Keep the product dry at all times. Do not use Mammoth Acoustic Panel Absorber in situations where the product will come into contact with water or moisture. Allow a minimum gap of 25mm from any building surface that is damp or may become damp during the intended use of the building.
- Avoid compression of the product, as it will adversely affect performance. Nominal thickness of the product should be maintained at all times.
- Use sufficient product so that a snug fit is achieved. Cut to required lengths using Tajima knife or other heavy duty blade.

#### RECOMMENDED TOOLS\*

- Insulation hangers
- Insulation hanger caps
- Contact adhesive and construction adhesive
- Tajima knife (model: LC-660) or similar heavy duty blade
- Steel ruler (and measuring tape)

\* Tools required may vary depending on the type of installation.

#### SAFETY PRECAUTIONS

When working near electrical cables and equipment, care should be taken to avoid damaging any electrical insulation. Wherever possible Mammoth Acoustic Panel Absorber should be laid behind electrical wiring (or pipes).

Refer to a registered electrician or qualified electrical engineer and/or AS/NZ 3000 for further guidance.

#### DISCLAIMER

Mammoth Panel Absorber is designed for acoustic applications. It is not recommended for visual applications as the surface may show creases, wrinkles or slight colour variations due to the manufacturing process.

#### CUTTING INSTRUCTIONS

Ensure you note where there is a service (e.g: electrical wiring) as you will need to cut the Acoustic Panel Absorber accordingly.

Cut Mammoth Acoustic Panel Absorber with a Tajima or other heavy duty blade.

### HOW TO INSTALL MAMMOTH PANEL ABSORBER

Mammoth Acoustic Panel Absorbers can be applied to walls and ceilings in a variety of ways. These include Friction Fitted into a frame, Glued and fixed using Insulation hangers. These instructions include Adhesive Fixing and Mechanical Fixing (with Insulation hangers).

#### ADHESIVE FIXING REQUIREMENTS

Ensure the surface is clean and dry.

- Measure the entire surface you are covering & ensure you have enough Panel Absorbers.
- Ensure surface meets adhesive requirements, all gaps and joints to be covered, substrate to be prepared to a minimum level 3 finish.
- Measure Mammoth Acoustic Panel Absorber and cut sheet to size if required.
- 2 adhesives must be used. Full coverage of contact adhesive on substrate and panel for primary adhesion combined with a secondary construction adhesive at minimum 150mm strips across the panel.
- Recommended 25mm negative detail, product can be butt joined but is not recommended for aesthetic reasons.
- For more details, refer to adhesive manufacturers recommendations.

#### MECHANICAL FIXING REQUIREMENTS

- Measure the entire surface you are covering & ensure you have sufficient Panel Absorbers to cover.
- Ensure you have sufficient Insulation hangers to complete a 600mm x 600mm spacing across the surface.
- Ensure surface meets adhesive requirements
- Using a pen or permanent marker, mark up where the Insulation hangers are to be positioned on the clean surface.
- Fix the Insulation hangers onto the surface with screws or nails. If using glue, apply a sufficient amount of construction adhesive glue onto the base and glue them to the surface. NB: ensure you maintain the 600mm centre intervals.

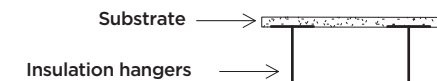

- For additional strength, apply contact adhesive and/or construction adhesive between the insulation hangers. Be mindful of porous surfaces with contact adhesive.
- Measure Mammoth Acoustic Panel Absorber and cut sheet to size.
- Line up the Mammoth Acoustic Panel Absorber to an outer edge first and then push the panel onto the Insulation hanger.
- For safety, note the Insulation hanger's position when applying onto the surface.
- Fix Insulation hanger caps onto the ends of the facing pins, so that it fits up against the Panel Absorber without compressing. If necessary, a suitable washer can be applied before the cap.

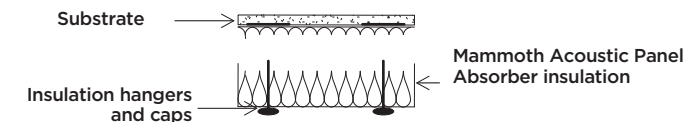

- If necessary, paint caps to match the colour of the Mammoth Acoustic Panel Absorber.

™ Mammoth Modern Insulation is a trademark of, and manufactured by InZone Industries Ltd.